



12 Moonee Street POTTSVILLE NSW

3 2 2

Sometimes properties need to be inspected to be appreciated. You can cycle through internet listings for hours on end and not get a genuine feel for a home, and that's a major thing to a lot of buyers that I sell to, it is how a property "FEELS" that can truly distinguish it from others. 12 Moonee Street with its raked ceilings and abundance of light is certainly one such property.

Featuring 3 extra large bedrooms with the master and 2 separate living areas enveloping the sun drenched courtyard and pebblecrete pool, there is an elegant practicality to the floorplan. The raked ceilings are a mesmerising feature throughout the home that drench the living areas in Northern sun light. Couple that with a neutral colour palette throughout, enormous designer ensuite,

Type : House
Price : \$ 800,000
Building Size : 21 sqm
Land Size : 641 sqm
View : <https://www.pottsvilleproperties.com/sale/nsw/northern-rivers/pottsville/residential/house/7644967>

[For full version visit the website](https://www.pottsvilleproperties.com)

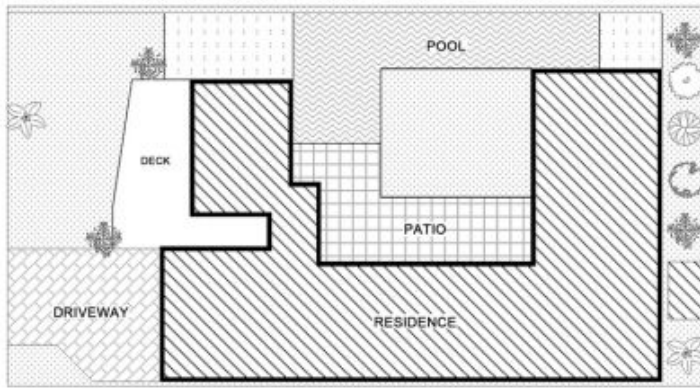

SITE PLAN
(NOT TO SCALE)



GROUND FLOOR

12 MOONEE STREET

POTTSVILLE

Floor Plan Disclaimer: Media Drive (MD) floor plans / site plans are intended as an approximate guide only. No representations or warranties of any nature are given or intended and any person using this information other than as a guide should always rely on their own enquiries. Media Drive property marketing services / 041973056 / Photography, Floor plans, Video, Aerial photography / www.mediaactive.com.au



Potterville Properties | Internal: 139m²
McLeod & Kelford Excludes all external structures
Eg. decks, patios, verandahs etc