



1/34 Royal Drive POTTSVILLE NSW

3 1 1

This townhouse is in a complex of only four, with low strata levies covering your building insurance and common property expenses. The property has great potential for future growth with its amazing location!

Features include:

- North facing kitchen with modern appliances and built in laundry
- Low maintenance polished concrete flooring
- Air Conditioning
- Under stair storage area
- Fully fenced yard
- Separate single lock up garage to the rear of the property
- Pets permitted subject to Owners Corporation approval
- Low Strata Levies

**Type** : Townhouse

**Price** : \$ 770,000

**View** : <https://www.pottsvilleproperties.com/sale/nsw/northern-rivers/pottsville/residential/townhouse/7645017>

[For full version visit the website](https://www.pottsvilleproperties.com)

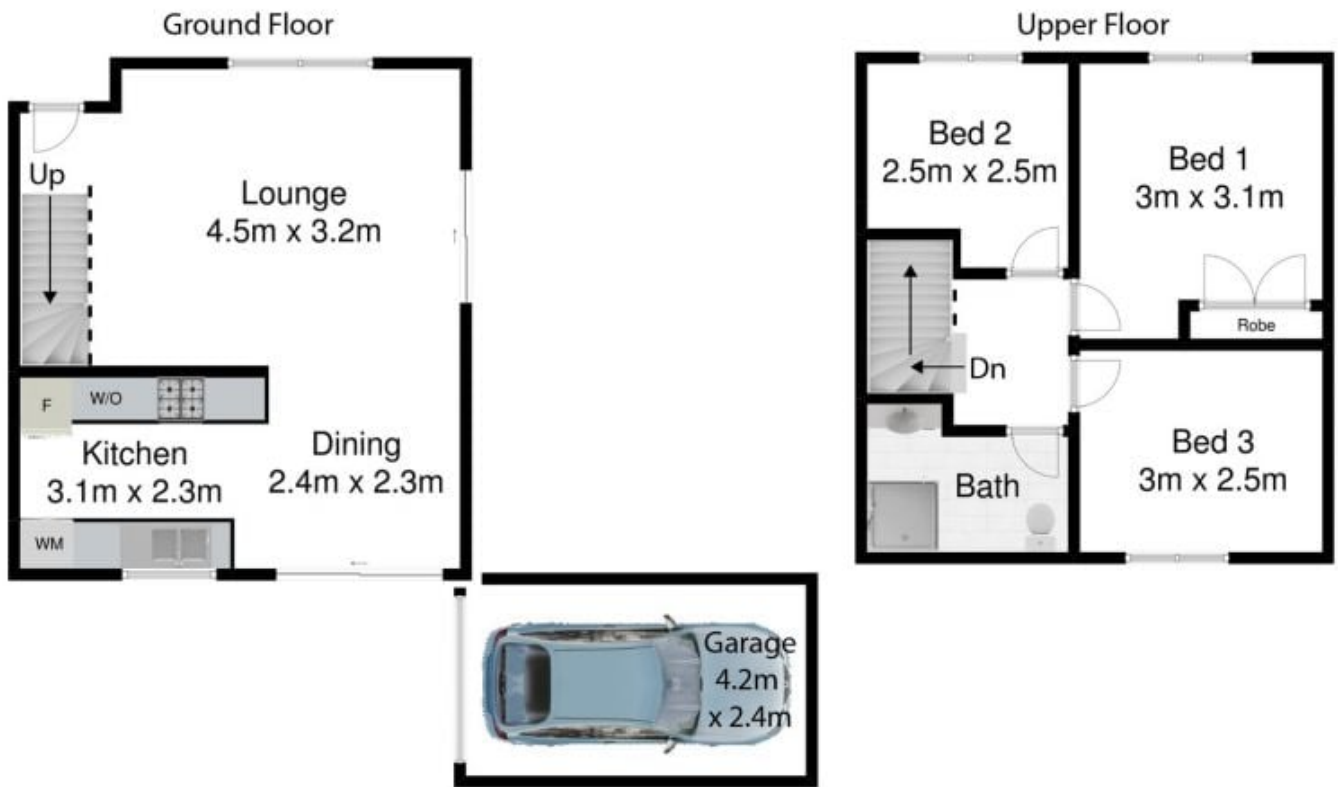

# 1/34 Royal Drive - Pottsville

0 1 2 3 4 5

Scale in meters. Indicative only.



This floorplan is for illustration purposes only and no warranty is given to its accuracy. Purchases are advised to carry out their own investigations.  
Produced by Friday Hut Studios.