



14 Newcastle Drive POTTSVILLE NSW

4 2 2

This customized display home had no expense spared when creating a modern and affluent property. Priced well under replacement cost, this home features a parents retreat with ensuite + walk-in wardrobe, 3 carpeted bedrooms, family bathroom, formal entryway, large study, formal lounge room/ media room, large open plan tiled living area and a state of the art kitchen.

Type : House
Land Size : 692 sqm
View : <https://www.pottsvilleproperties.com/sale/nsw/northern-rivers/pottsville/residential/house/7645137>

Boasting modern inclusions, such as fully ducted zoned air conditioning, top class light fittings, stainless steel appliances and a back to base full alarm system, this property is superior in quality!

Externally, the property has an undercover patio & bbq area and a large grassed backyard with plenty of room for a

[For full version visit the website](#)

Builder's Copy

N2.

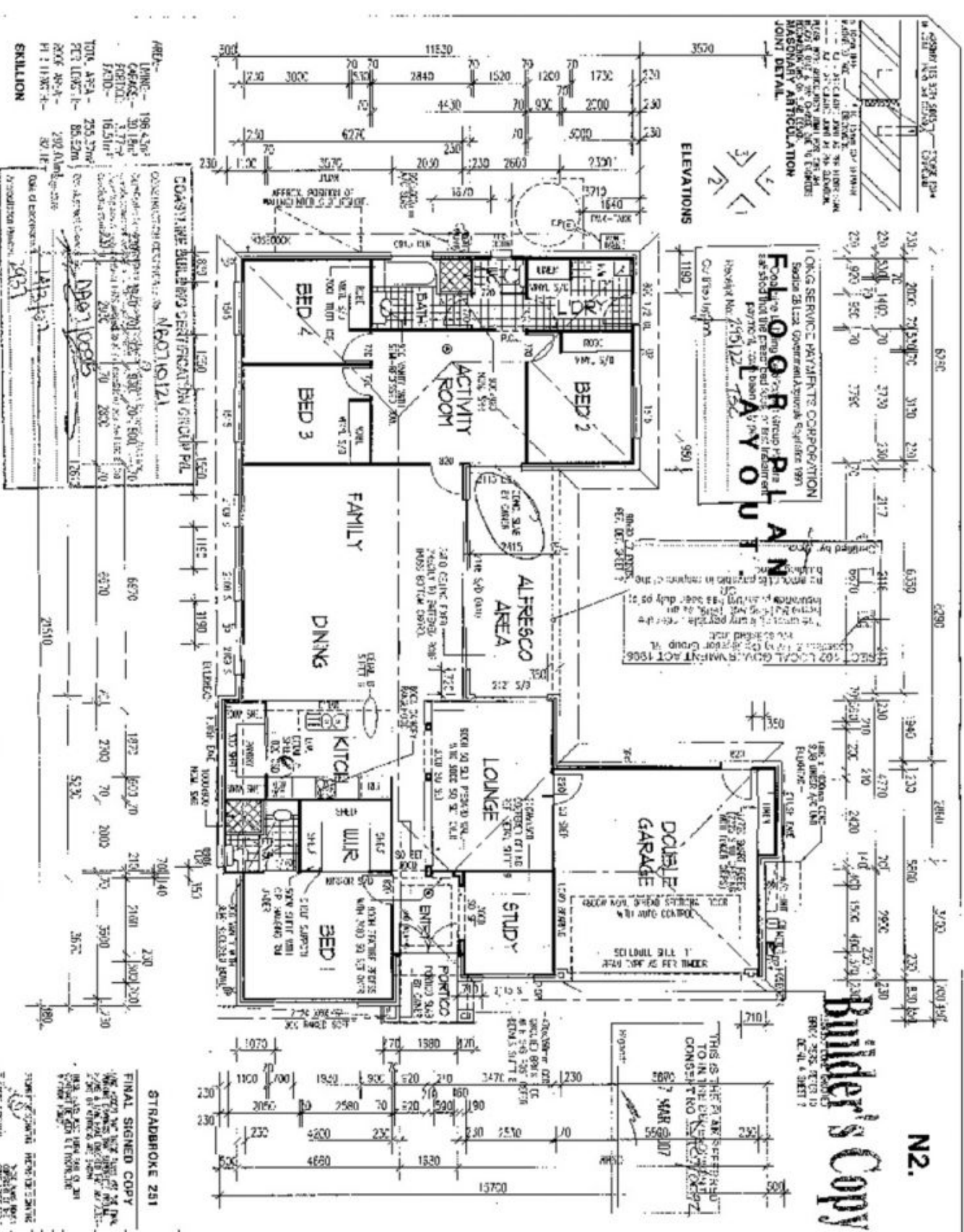

ARCH:
 LINDA - 196 420
 CAROL - 30 184
 FORTUNA - 3 777
 JASID - 16 514
 TOM, AYESA - 255 270
 PEG, LORRY - 88 520
 ROSE, ANA - 292 040
 PI - 11 853

SKILLION

CONSTRUCTION CONTRACT NO. N60710121
 COMSTABLE BUILDERS DEVELOPMENT GROUP P/L

STRADBROKE 251

FINAL SIGNED COPY

CONTRACT NO. N60710121

DATE: 15/07/07

SCALE: 1 OF 11

CONTRACT NO. N60710121

DATE: 15/07/07

SCALE: 1 OF 11

CONAL HOMES PTY LTD
 25 BENTLEY DRIVE, BENTLEY VIC 3185
 TEL: 03 9450 1000
 FAX: 03 9450 1001
 WWW.CONALHOMES.COM.AU

CONAL HOMES
 "Build On Trust"

NOTES

1. THIS IS THE FINAL SIGNED COPY OF THE FLOOR PLAN TO BE USED FOR CONSTRUCTION PURPOSES ONLY. IT IS NOT TO BE USED FOR ANY OTHER PURPOSES.

2. THE FLOOR PLAN IS THE PROPERTY OF CONAL HOMES PTY LTD AND IS NOT TO BE REPRODUCED OR COPIED IN ANY MANNER WITHOUT THE WRITTEN PERMISSION OF CONAL HOMES PTY LTD.

3. THE FLOOR PLAN IS TO BE USED IN ACCORDANCE WITH THE BUILDING REGULATIONS AND STANDARDS APPLICABLE AT THE TIME OF CONSTRUCTION.

4. THE FLOOR PLAN IS TO BE USED IN ACCORDANCE WITH THE CONTRACT DOCUMENTS AND SPECIFICATIONS.

5. THE FLOOR PLAN IS TO BE USED IN ACCORDANCE WITH THE BUILDING REGULATIONS AND STANDARDS APPLICABLE AT THE TIME OF CONSTRUCTION.

LEGEND

1. FLOOR FINISH
 2. WALL FINISH
 3. CEILING FINISH
 4. DOOR FINISH
 5. WINDOW FINISH
 6. STAIR FINISH
 7. BALCONY FINISH
 8. TERRACE FINISH
 9. DRIVEWAY FINISH
 10. GARAGE FINISH
 11. POOL FINISH
 12. FENCE FINISH
 13. GARDEN FINISH
 14. PAVING FINISH
 15. ROOF FINISH
 16. CLADDING FINISH
 17. GLASS FINISH
 18. METAL FINISH
 19. WOOD FINISH
 20. STONE FINISH
 21. BRICK FINISH
 22. CONCRETE FINISH
 23. ASPHALT FINISH
 24. GRASS FINISH
 25. SAND FINISH
 26. GRAVEL FINISH
 27. SLAB FINISH
 28. CURB FINISH
 29. GUTTER FINISH
 30. DOWNPIPE FINISH
 31. RAINWATER FINISH
 32. AIR CONDITIONING FINISH
 33. HEATING FINISH
 34. COOLING FINISH
 35. EXHAUST FINISH
 36. VENT FINISH
 37. DUCT FINISH
 38. CHIMNEY FINISH
 39. ROOF RAKE FINISH
 40. GABLE FINISH
 41. RIDGE FINISH
 42. EAVE FINISH
 43. SOFFIT FINISH
 44. BATTEN FINISH
 45. SHINGLE FINISH
 46. CORRUGATED FINISH
 47. COLORBOND FINISH
 48. GALVALUME FINISH
 49. ZINC FINISH
 50. COPPER FINISH
 51. LEAD FINISH
 52. SLATE FINISH
 53. TERRAZZO FINISH
 54. POLISHED FINISH
 55. HONED FINISH
 56. MATTE FINISH
 57. GLOSS FINISH
 58. SATIN FINISH
 59. ENAMEL FINISH
 60. EPOXY FINISH
 61. POLYURETHANE FINISH
 62. ACRYLIC FINISH
 63. VINYL FINISH
 64. LAMINATE FINISH
 65. GLASS FINISH
 66. METAL FINISH
 67. WOOD FINISH
 68. STONE FINISH
 69. BRICK FINISH
 70. CONCRETE FINISH
 71. ASPHALT FINISH
 72. GRASS FINISH
 73. SAND FINISH
 74. GRAVEL FINISH
 75. SLAB FINISH
 76. CURB FINISH
 77. GUTTER FINISH
 78. DOWNPIPE FINISH
 79. RAINWATER FINISH
 80. AIR CONDITIONING FINISH
 81. HEATING FINISH
 82. COOLING FINISH
 83. EXHAUST FINISH
 84. VENT FINISH
 85. DUCT FINISH
 86. CHIMNEY FINISH
 87. ROOF RAKE FINISH
 88. GABLE FINISH
 89. RIDGE FINISH
 90. EAVE FINISH
 91. SOFFIT FINISH
 92. BATTEN FINISH
 93. SHINGLE FINISH
 94. CORRUGATED FINISH
 95. COLORBOND FINISH
 96. GALVALUME FINISH
 97. ZINC FINISH
 98. COPPER FINISH
 99. LEAD FINISH
 100. SLATE FINISH